

# Hoyt's Serpa™ Flat Fill Helps Vermont Quarry Boost Throughput



Plant manager Ron King had many of the typical problems aggregate materials producers experience with screening at Twin State quarry in White River Junction, VT.

Traditional screens with rubber or polyurethane bindings were wearing out quickly in the crushed granite line. And, as they aged, their sizing accuracy deteriorated.

Fortunately, Hoyt Wire Cloth, had a solution: Serpa™ Flat Fill, a new product in Hoyt's already robust wire cloth line.

After talking to Hoyt, King realized that the new product could improve the wear life of his screens. More importantly, the new screens would allow better throughput, helping him improve productivity. And the improved sizing accuracy would make it easier to meet specifications for aggregate and asphalt.

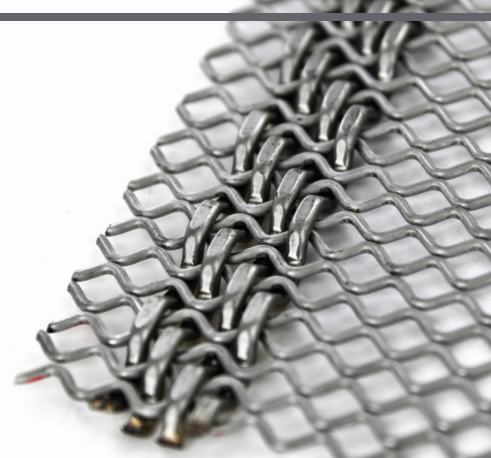

Patent US11517939B1

## EXCEEDED EXPECTATIONS

King agreed to install one-inch Serpa .250 Wire Flat Fill screening in a scalping and crushing line, after the tertiary crusher. And the results have exceeded expectations.

*"The Serpa Flat Fill screens have improved both our line throughput and the sizing accuracy of our product," King said. "And they are lasting much longer than our previous screens."*

In addition, King's maintenance teams found the new screens were lighter and easier to install.

*"My maintenance personnel said the Serpa Flat Fill was lighter, because it didn't have rubber on the bindings," King said. "So, it was easier to install."*

King said he intends to explore other areas of his operation to see if Serpa Flat Fill would be appropriate.

Hoyt's Serpa Flat Fill is a patented metal flat-fill wire screen that improves the screening of aggregate materials. It reduces cost, improves productivity, and is more sustainable than traditional screens with polyurethane bindings.

## HOW HOYT SERPA™ FLAT FILL WORKS

### Current Screens

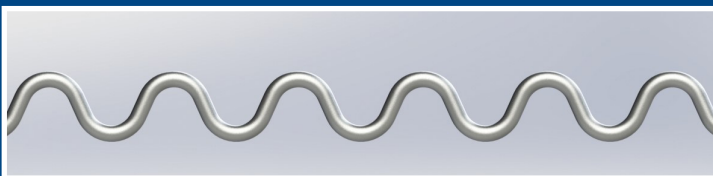

Current screens have fill wires with a V-shaped pattern. As a result, the knuckles on the top of the screen wear out from usage.

### Hoyt Serpa™ Flat Fill

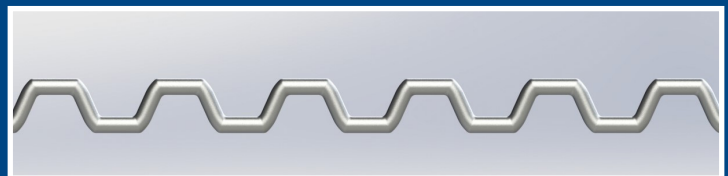

Hoyt Serpa™ Flat Fill is engineered to increase open area and boost production of accurately sized material. Its patented shape flattens out the knuckles reducing wear and tear.

And, because it's made in Hoyt's facilities, it is readily available, allowing lead times to be shorter than for screens with polyurethane bindings or other competitive products.

Serpa Flat Fill is just one of many high-quality Hoyt woven wire cloth products designed to meet the needs of the aggregates industry. Hoyt is powered by Fenner Drives, and is part of Fenner Precision Polymers, a Michelin Group company.



US and Canada 1-800-243-3374  
Latin America 1-717-665-2421  
Europe, Asia, Australia and Africa +44 0 870 757 7007

[www.hoytwirecloth.com](http://www.hoytwirecloth.com)    

© 2023 FENNER PRECISION POLYMERS FPP\_FL\_Flat-Fill-Twin-State\_23-09\_V1